

New 1 Amp, 100V Schottky Bridge Rectifier in the HD DIP

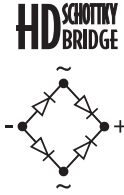

CBRHDSH1-100



features

- $V_{RRM} = 100V$
- $I_O = 1.0A$ (CBRHDSH1-100)
- $V_F = 0.7V$ TYP. @ 1.0A (CBRHDSH1-100)
- Ideal for PoE Applications

description

The New Central Semiconductor CBRHDSH1-100 is a full wave oxide passivated Schottky bridge rectifier manufactured in a durable HD DIP surface mount package. Designed for applications requiring an energy efficient alternative to standard general purpose bridge rectification and Power over Ethernet (PoE) applications.

Sample Devices available upon request.

selection guide



I_O (AMPS)	1.0	2.0
@ T_A (°C)	25	25
I_{FSM} (AMPS)	20	30
CASE		
V_{RRM} (VOLTS)	SCHOTTKY	SCHOTTKY
40	CBRHDSH1-40L	CBRHDSH2-40
60	CBRHDSH1-60†	–
100	CBRHDSH1-100	–
V_F max @ I_F	0.44V @ 1.0A 0.75V @ 1.0A*	0.50V @ 2.0A
I_R max @ V_{RRM}	50µA @ 40V 10µA @ 100V*	50µA @ 40V

NEW

† Under Development * 100V device.

The HD DIP package utilizes 50% less board space compared with 4 individual SMA Schottky Rectifiers in a bridge configuration.

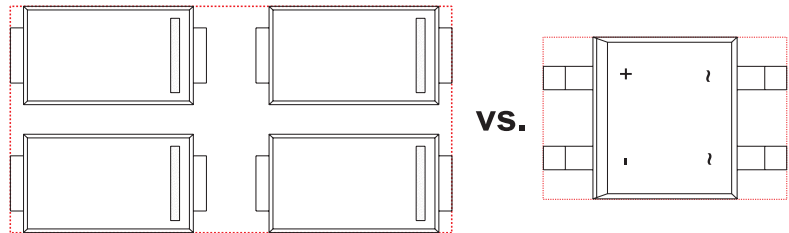

4 SMA packages

HD DIP package

New 1 Amp, 100V Schottky Bridge Rectifier in the HD DIP

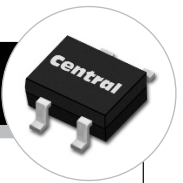

Mechanical Specifications - HD DIP

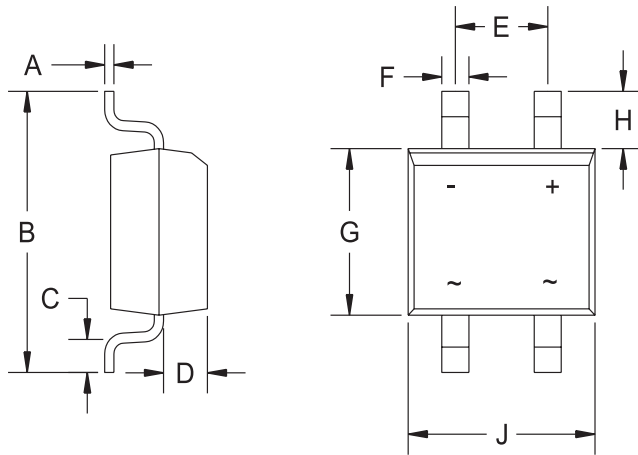

SYMBOL	INCHES		MILLIMETERS	
	MIN	MAX	MIN	MAX
A	0.006	0.014	0.15	0.35
B	-	0.276	-	7.00
C	0.028	0.043	0.70	1.10
D	0.035	0.051	0.90	1.30
E	0.091	0.106	2.30	2.70
F	0.020	0.031	0.50	0.80
G	0.142	0.157	3.60	4.00
H	0.051	0.067	1.30	1.70
J	0.177	0.193	4.50	4.90
K	0.091	0.106	2.30	2.70
L	-	0.008	-	0.20
M	-	0.118	-	3.00

HD DIP (REV: R1)

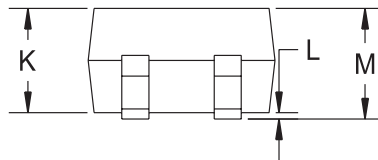

MARKING CODE:

CBRHDSH1-100 CSH110

MARKING CODE :

CBRHDSH1-40L CSH1

CBRHDSH2-40 CSH2

R1

Tape Dimensions and Orientation (Dimensions in mm)

Tape Width: 12mm

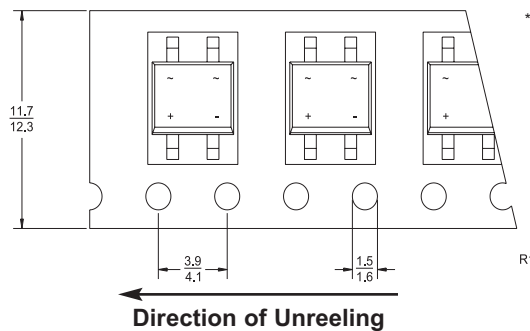

* Devices are taped in accordance with Electronic Industries Association Standard EIA-481-1-A

R1

Mounting Pad Geometry (Dimensions in mm)

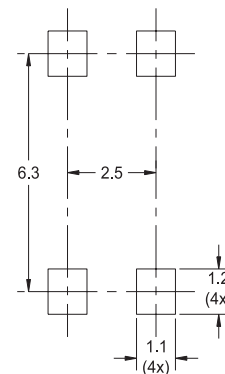

R1

CentralTM
Semiconductor Corp.

Innovations in Discrete Semiconductors

For further information contact:
Sales at Central Semiconductor Corp.
(631) 435-1110 or visit our website at:
www.centalsemi.com

145 Adams Avenue • Hauppauge • New York • 11788 • USA • Tel:(631) 435-1110 • Fax:(631) 435-1824

PA CBRHDSH1-100